

MX-004 TOKEN TRAY

Check out our BB-100 universal storage solution for small bits! We have a multitude of build possibilities to fit every need.

Plus, our bit boxes are designed to fit inside the card lanes of most of our inserts, so you will always know where your bits are! Let Go7 help you store your bits in style.

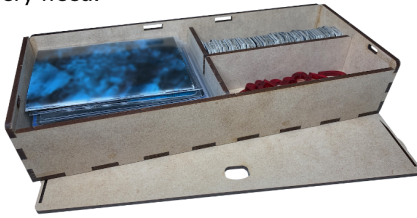

<http://go7gaming.com/product-category/bit-boxes/>

Go7 Gaming Heritage Line Inserts

This line of inserts utilizes acrylic dividers and includes a base for the insert, in most cases. These inserts are structurally designed to provide a rock-solid enclosure to protect your cards and bits for a lifetime. Of course, they cost more to produce and to ship. Also, because of the inclusion of the base, they are a little easier to build. The insert base provides an almost foolproof platform for building.

<http://go7gaming.com/product-tag/heritage/>

Go7 Gaming Value Line Inserts

Our Value Line inserts lack bases, but provide additional structural support via strategically placed supports. Also, we use wood dividers instead of acrylic dividers. With these changes, the cost of Value Line inserts is significantly less than our Heritage Line inserts, as well as competitor's equivalent inserts. Plus, we have designed our Value Line inserts to fit into less expensive USPS flat-rate envelopes. This is a huge win for U.S. customers and will also reduce the shipping costs for our international customers.

<http://go7gaming.com/product-tag/valueline/>

Go7 Gaming, Inc.
6001 W. Parmer Ln
Suite 370-119
Austin, TX 78727

MADE IN THE USA

Copyright 2022, Go7 Gaming. All Rights Reserved. All trademarks/marks are the property of their respective owners. Visit go7gaming.com. Twitter: [@go7gaming](https://twitter.com/go7gaming) and Facebook: [go7gaming](https://facebook.com/go7gaming)

FOR USE WITH MX-003



ESTIMATED CONSTRUCTION TIME: 10 MINUTES, EACH UNIT

MATERIALS REQUIRED: [GLUE](#)

KIT INCLUDES: 2x MX-004 TOKEN TRAYS

NOT A CHILDREN'S TOY

AGE 14+



General Construction Tips

1) Each piece should be removed from the frames with gentle pressure back and forth. You should not need a knife to cut pieces free.

2) Our inserts are designed to be glued together. We use Sobo craft glue, but any glue that is tacky and dries clear will work fine. Tacky glue assists with building as it holds better during construction. You can use painter's/masking tape for some joins, but glue is always best.

3) Keep some paper towels handy for cleanup during build.

4) Ensure you cleanup excess glue as you build. This is especially important in card lanes where dividers will be used or in spaces where a tray will be stored. The small, thin sticks on your plates are for glue removal.

5) Always dry fit pieces first to ensure a good fit and to better understand how the kit goes together before gluing!

6) Allow your finished trays to dry overnight.

7) Don't hesitate to reach out to us if you have questions!

Kit Plates

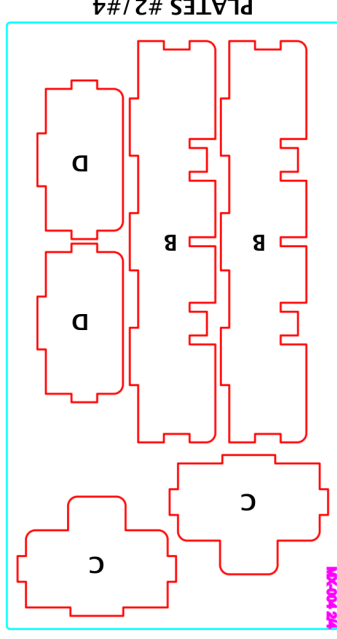
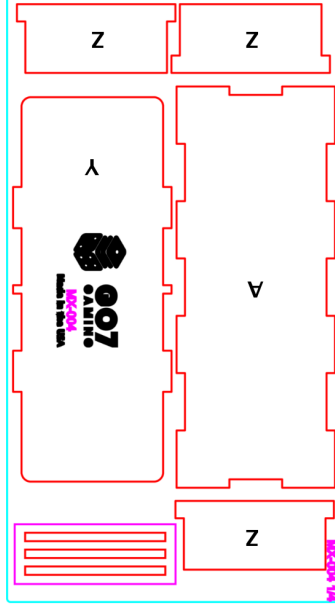

3D Model

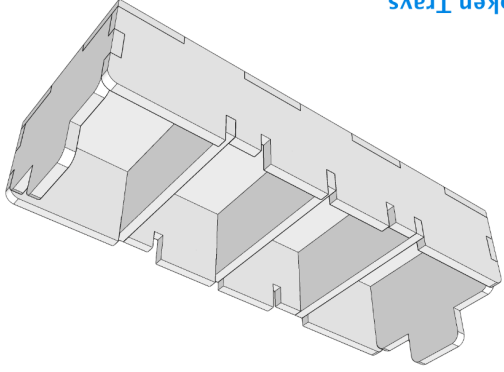

Building the Token Trays

These trays have two possible builds. You can build the end walls using either the C part (designed for use in the MX-003 organizer) or D (for anything else). Substitute your preferred option during the build steps below.

0) Punch out the three glue cleanup sticks on plate #1/#3 for use during construction.
 1) Place base (A) down on your workspace in the orientation noted below.
 2) Next, apply glue to the bottom and side tabs of wall (C or D) and connect to base (A).
 3) Next, apply glue to the bottom of wall (B) and connect to base (A). Repeat on the other side.
 4) Next, apply glue to the bottom and side tabs of wall (C or D) and connect to base (A).
 5) Finally, place the splitters (Z) in the tray and place the lid (Y) on the tray and allow the tray to dry overnight.

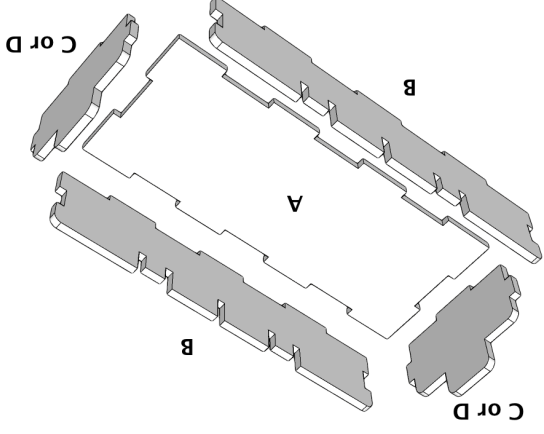

6) Repeat build for the second tray.

Congratulations! You have completed the construction of your token trays. Allow your trays to dry overnight and then fill them! If you have any questions/concerns, don't hesitate to contact us. Finally, please take a moment to review your new trays on our website.