

AQIBASE-001 INSERT

Model AQIBASE-001 Miniatures Insert Kit for Arcadia Quest: Inferno™ Base Box

Complete insert kit providing storage for miniatures, cards, map tiles, and tokens



General Construction Tips

- 1) Each piece should be removed from the frames with gentle pressure back and forth. You should not need a knife to cut pieces free.
- 2) Our inserts are designed to be glued together. We use Sobo craft glue, but any glue that is tacky and dries clear will work fine. Tacky glue assists with building as it holds better during construction. You can use painter's/masking tape for some joins, but glue is always best.
- 3) Keep some paper towels handy for cleanup during build.
- 4) Ensure you cleanup excess glue as you build. This is especially important in card lanes where dividers will be used or in spaces where a tray will be stored.
- 5) Check the build diagram included in the package for reference, including all parts, as well as build tips specific to this insert.
- 6) Always dry fit pieces first to ensure a good fit and to better understand how the kit goes together.
- 7) Allow your finished insert to dry overnight.
- 8) You can optionally sand and even stain your insert.
- 9) Don't hesitate to reach out to us if you have questions!

Unlike many of our inserts, this is not a licensed insert. All trademarks/marks are the property of their respective owners.

NOT A CHILDREN'S TOY

AGE 14+

Visit go7gaming.com for a large selection of storage solutions.

Follow us on Twitter: [@go7gaming](https://twitter.com/go7gaming) and Facebook: [go7gaming](https://facebook.com/go7gaming)

GO
GAM7ING

Made in the USA

Build Instructions

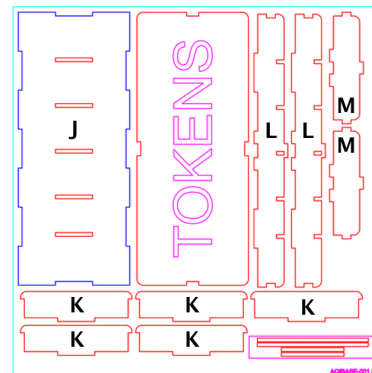
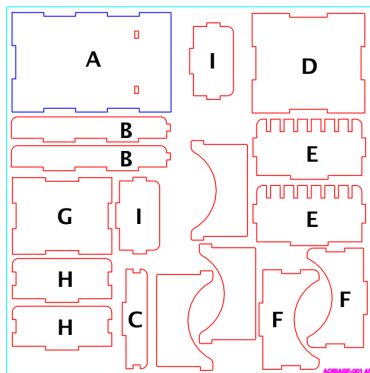

Please reference the diagrams to understand how each component goes together. Also, dry fit the pieces to understand how it goes together and ensure everything is oriented properly before applying glue. Finally, cleanup excess glue to ensure a proper fit and finish, especially in card and rail areas.

Building the Jumbo Tray

- 1) Place base (A) down on your workspace in the orientation noted to the right.
- 2) Next, apply glue to the bottom and end tab of side wall (B) and connect.
- 3) Next, place glue on the bottom of front wall (C) and connect.
- 4) Finally, apply glue to the bottom and end tab of side wall (B) and connect.

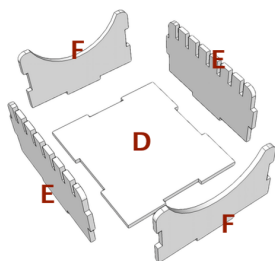
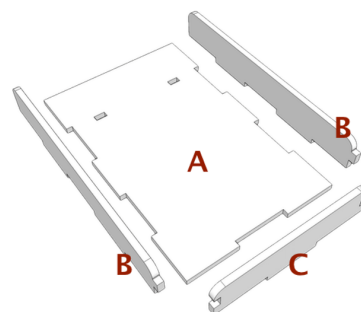

Building the Small Card Tray

- 1) Place base (D) down on your workspace in the orientation noted to the left.
- 2) Next, apply glue to the bottom and end tabs of side wall (E) and connect.
- 3) Next, place glue on the bottom of front wall (F) and connect.
- 4) Next, place glue on the bottom of rear wall (G) and connect.
- 5) Finally, apply glue to the bottom and end tabs of side wall (E) and connect.
- 6) Once the glue has a few minutes to set, you can place a couple of dividers in the tray to ensure a perfect fit.

Building the Dice Storage Tray

- 1) Place base (G) down on your workspace in the orientation noted to the right.
- 2) Next, apply glue to the bottom and end tabs of side wall (H) and connect.
- 3) Next, place glue on the bottom of front wall (I) and connect.
- 4) Next, place glue on the bottom of rear wall (J) and connect.
- 5) Finally, apply glue to the bottom and end tabs of side wall (H) and connect.

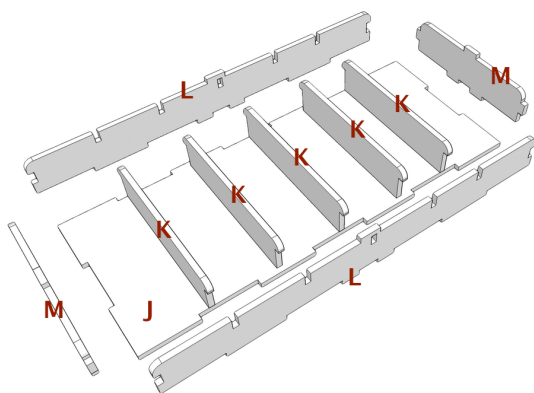
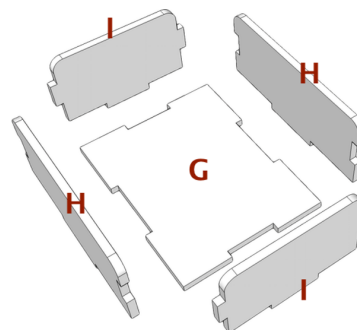

Building Token Tray #1

- 1) Place base (J) down on your workspace in the orientation noted to the left.
- 2) Next, apply glue to the bottom of each inner wall (K) and connect to base (J).
- 3) Next, apply glue to the end tabs on one side of the inner walls (K), the bottom of the rear wall (L), and then connect to base (J). Repeat for front wall (L).

Note: ensure the small cutout on the bottom in the center of each (L) wall is clear of glue. This is a stacking notch. The same applies for the side walls (M).

- 4) Next, apply glue to the bottom and end tabs of side wall (M) and connect. Repeat for the other side wall (M).
- 5) Once the glue has a few minutes to set, you can place the "TOKENS" lid on the tray to ensure a perfect fit.

Build Instructions

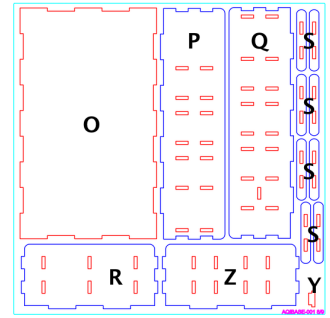
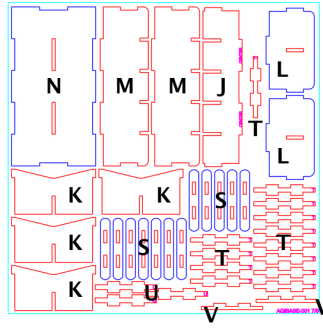
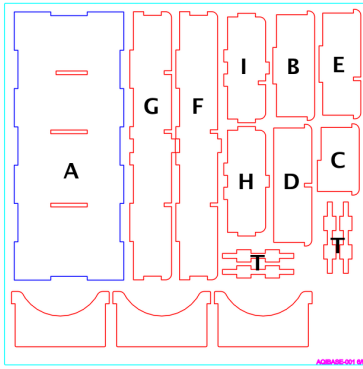

Please reference the diagrams to understand how each component goes together. Also, dry fit the pieces to understand how it goes together and ensure everything is oriented properly before applying glue. Finally, cleanup excess glue to ensure a proper fit and finish, especially in card and rail areas.

Building Token Tray #2

- 1) Place base (A) down on your workspace in the orientation noted to the right.
- 2) Next, apply glue to the bottom of inner wall (B) and connect to base (A).
- 3) Next, apply glue to the bottom inner wall (E) and connect to base (A).
- 4) Next, apply glue to the bottom and right end tab of inner wall (D) and connect.
- 5) Next, apply glue to the bottom and front end tab of inner wall (C) and connect.
- 6) Next, apply glue to the bottom of rear wall (G) and the end tabs of the inner dividers touching it and connect.

Note: ensure the small cutout on the bottom in the center of each (F, G) wall is clear of glue. This is a stacking notch. The same applies for (H, I) walls.

- 7) Next, apply glue to the bottom of front wall (F) and the end tabs of the inner dividers touching it and connect.
- 8) Next, apply glue to the bottom and end tabs of side wall (I) and the end tab of inner wall (D) touching it and connect.
- 9) Finally, apply glue to the bottom and end tabs of side wall (H) and connect.

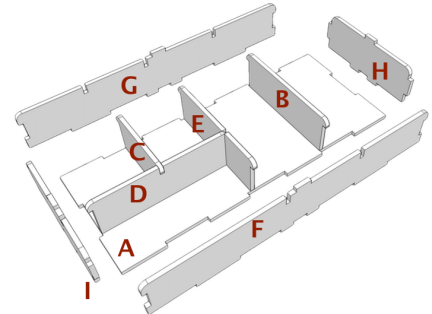

Building the Small Minis Tray

- 1) Place base (N) down on your workspace in the orientation noted to the left.
- 2) Next, apply glue to the bottom of inner wall (J) and connect to base (N).
- 3) Next, apply glue to the bottom and end tabs of both side walls (L) and connect.
- 4) Next, place glue on the bottom of the front and rear walls (M) and connect.
- 5) Finally, apply glue to the end tabs of each inner divider (K) and connect.

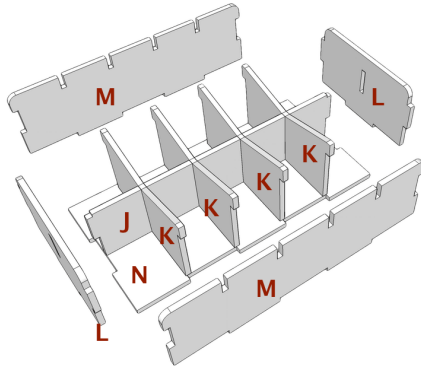
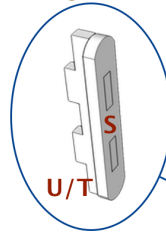

Figure #1



T: Demoness B: Phyx	T: Harpie B: Phyx	T: Leah B: Mark	T: Jaimie B: Jack-Jack	T: Sybbyl B: Wanderer
Cerberus				
Cerberus				
T: Trandir B: Bjor	T: Harpie B: Harpie	T: Justicar B: Angel Eyes	T: Cassius B: Demoness	

Storage Plan

Building the Large Minis Tray

- 1) Place base (O) down on your workspace in the orientation noted to the right.
- 2) Next, build the rail assemblies per Figure #1. Note that three of the rail assemblies use support (U) and will be attached to side wall (R), while the rest use support (T). The three (U) supports are thicker for larger mini bases.
- 3) Next, attach the three (U) rail assemblies with glue to side wall (R). **Note:** cleanup excess glue to ensure a smooth sliding action on all rails and rail assemblies.
- 4) Next, attach the rest of the (T) rail assemblies to the other walls (P, Q, Z) using glue.
- 5) Next, attach the two rails (V) to the end of each long wall (P, Q) using glue.
- 6) Next, apply glue to the tab on bottom support (Y) and connect to long wall (Q).
- 7) Next, apply glue to the bottom and end tabs of side wall (R) and attach.
- 8) Next, apply glue to the bottom of long wall (Q) and attach.
- 9) Next, apply glue to the bottom and end tabs of side wall (Z) and attach.
- 10) Finally, apply glue to the bottom of the other long wall (P) and attach.

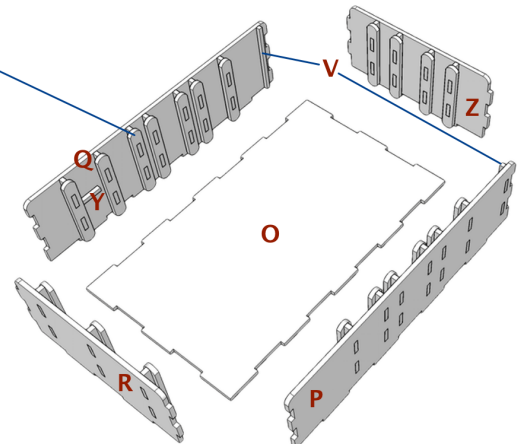

Build Instructions

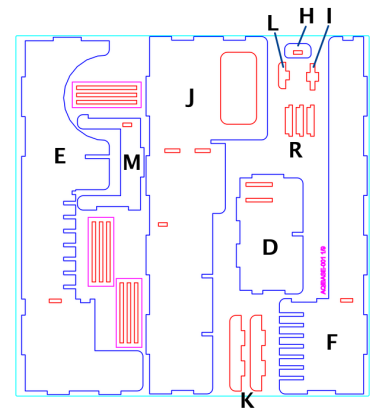
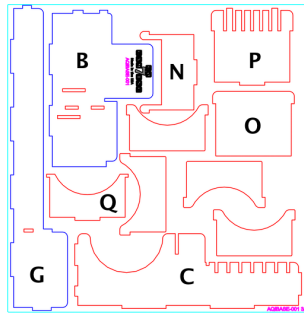
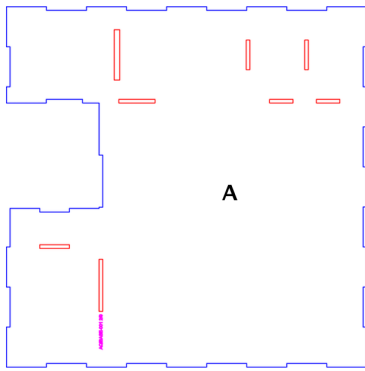

Please reference the diagrams to understand how each component goes together. Also, dry fit the pieces to understand how it goes together and ensure everything is oriented properly before applying glue. Finally, cleanup excess glue to ensure a proper fit and finish, especially in card and rail areas.

Building the Base Insert

- 1) Place base (A) down on your workspace in the orientation noted below.
- 2) Next, place glue on the right end tabs of inner card wall (C) and connect to inner minis wall (B).
- 3) Next, place glue on the bottom of the structure you built in #2 and connect to base (A).
- 4) Next, glue support (I) to rail (H) as shown in figure #1 and then glue the rail assembly to rear wall (J) with the longer side towards low divider (M).
- 5) Next, glue rail (K) to rear wall (J).
- 6) Next, glue rail (K) to inner minis wall (B).
- 7) Next, glue rail (L) to low divider (M) as shown in figure #2.
- 8) Next, place glue on left end tabs and bottom of low divider (M) and the right tab and bottom of short minis wall (D) and connect to base (A).
- 9) Next, place glue on the left end tab and bottom of high divider (N) and connect to short minis wall (D) and base (A).
- 10) Next, place glue on the bottom of rear wall (J) and the right tabs of the two dividers connected to short minis wall (D) and connect to base (A).
- 11) Next, place glue on the end tabs and bottom of side wall (E) and the left end tabs of inner minis wall (B) and connect.
- 12) Next, place glue on the left end tabs of inner card wall (C) and the bottom of front wall (F) and connect.
- 13) Next, place glue on the end tabs and bottom of side wall (G) and the right end tabs of short minis wall (D) and connect.
- 14) Next, place glue on the end tabs of tall divider (O) and connect.
- 15) Next, place glue on the bottom and end tabs of card divider wall (P) and connect.
- 16) Next, place glue on the bottom and end tabs of short wall (Q) and connect.
- 17) Finally, place glue on the tab of each map tile stop (R) and connect.

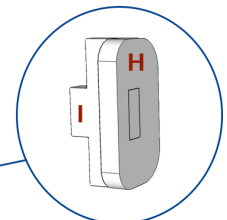

Figure #1

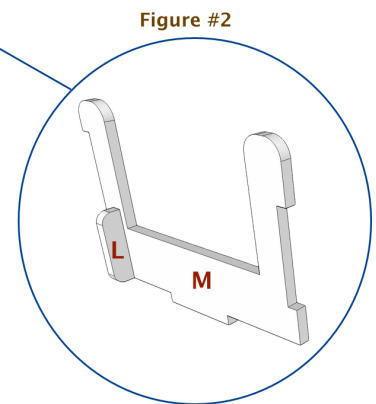
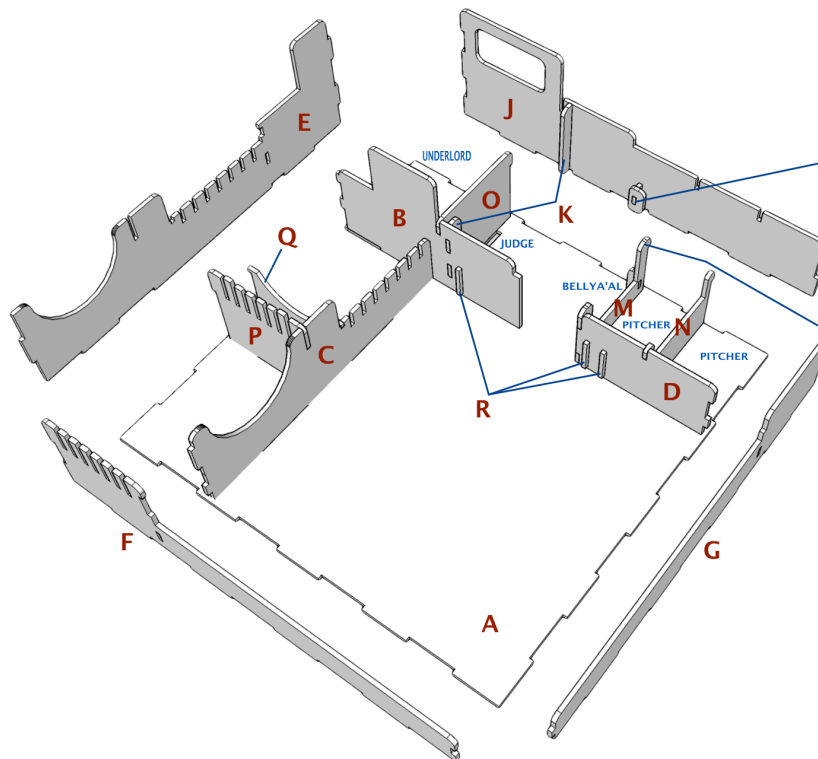

Figure #2



Congratulations! You have completed the construction of your new storage insert. If you have any questions/ concerns, don't hesitate to contact us. Finally, please take a moment to review your new solution on our website.