

MW-005 INSERT

Step #6: Place glue on both sides of the tab on the left end of support (B) and connect to the structure.

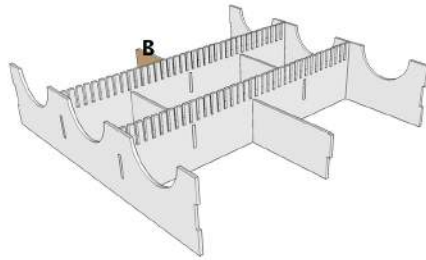
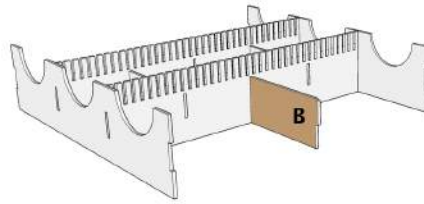

Step #7: Repeat step #6 for the final support piece (B) on the other side.

Step #8: Place glue on both sides of the exposed tab of support (B) and on both ends of outer wall (E), where it connects to the other outer walls at the corners.

While support (B) requires glue, you can optionally use masking or painter's tape to connect the corners of the insert.

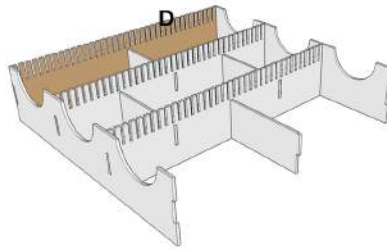

Step #9: Repeat step #8 on the other side.

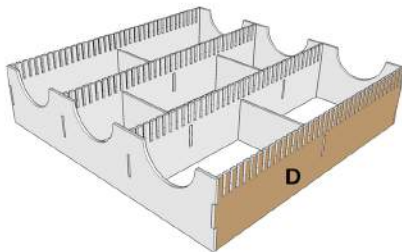

Congratulations! You have completed the construction of your new insert. Allow your insert to dry overnight, place it in your game box, and organize your cards. If you have any questions/concerns, don't hesitate to contact us. Finally, please take a moment to review your new insert on our website.

VALUE LINE



THIS INSERT KIT FITS INSIDE THE MAGE WARS ARENA BOX

ESTIMATED CONSTRUCTION TIME: 20 MINUTES

MATERIALS REQUIRED: GLUE, MASKING/PAINTER'S TAPE

**KIT INCLUDES: (1x) MW-005 INSERT KIT
(12x) MW-DIVA-005 DIVIDERS**

General Construction Tips

- 1) Each piece should be removed from the frames with gentle pressure back and forth. You should not need a knife to cut pieces free.
- 2) Our inserts are designed to be glued together. We use Sobo craft glue, but any glue that is tacky and dries clear will work fine. Tacky glue assists with building as it holds better during construction. You can use painter's/ masking tape for some joins, but glue is always best.
- 3) Keep some paper towels handy for cleanup during build.
- 4) Ensure you cleanup excess glue as you build. This is especially important in card lanes where dividers will be used or in spaces where a tray will be stored.
- 5) Always dry fit pieces first to ensure a good fit and to better understand how the kit goes together.
- 6) Allow your finished insert to dry overnight.
- 7) Don't hesitate to reach out to us if you have questions!

3D Model

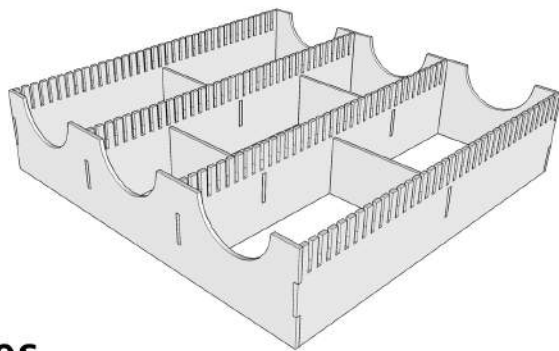

Kit Plates

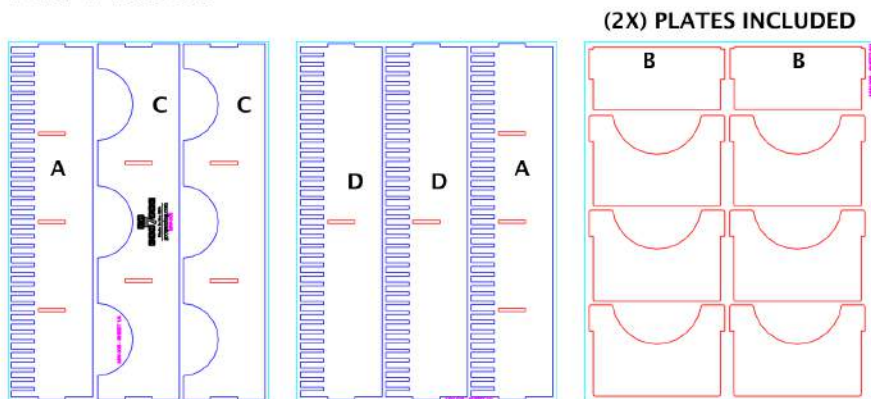

Step #1: Place glue on both sides of the tab on the left end of support (B) and connect it to inner wall (A).

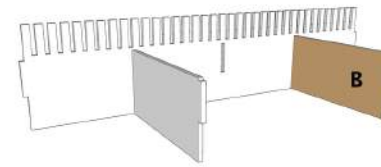
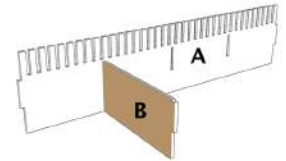

Step #2: Place glue on both sides of the tab on the left end of a second support (B) and connect it to inner wall (A).

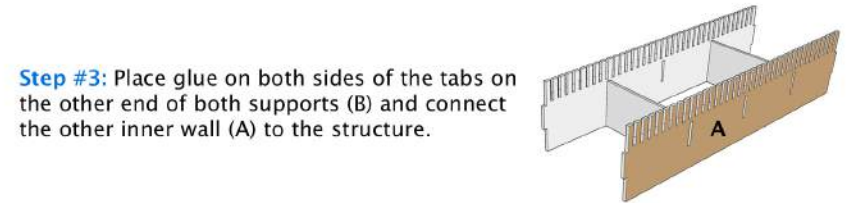

Step #3: Place glue on both sides of the tabs on the other end of both supports (B) and connect the other inner wall (A) to the structure.

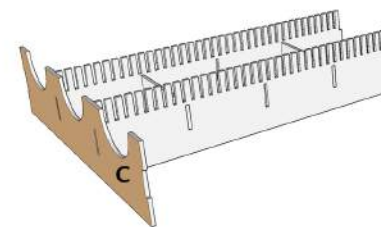

Step #4: Place glue on both sides of the tabs on the left end of both inner walls (A) and connect them to outer wall (C).

Step #5: Repeat step #4 on the other side.

